

MacDaddy Fishing Lights™

Fishing With Technology

USER MANUAL

MacDaddy Smart Light® Series
MacDaddy Single Mode™ Series

Warning – DO NOT USE AS A DOCK LIGHT



MACDADDY
FISHING LIGHTS®



CONTENTS

Warranty Registration

Packaging Contents

Smart Light Multimode Features

Top Light Flotation Kit Assembly

Bottom Light Accessories Assembly

Setting Up the Light Anchor Rope Rigging

Light Anchor Weight Specifications

MacDaddy Fishing Light Specifications

Battery Type Recommendations

Warranty Information

Product Safety Warning

Light Maintenance

Customer Service & Educational Resources

FISHING WITH TECHNOLOGY

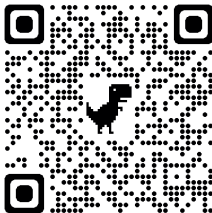

ATTENTION!

Warranty Registration – [LeeNoga.com/warranty](http://www.leenoga.com/warranty)

- *Warranty claims require a proof of purchase for every light.*
- *Direct purchases from Marker69.com are automatically registered.*
- *Purchases from our distributors require online warranty registration.*
- *Prepare image of receipt to be uploaded into your warranty registration.*
- *The image must clearly show the date of purchase.*
- *PC's – Go to **www.leenoga.com** and select warranty from the menu.*
- *Cell phones – Scan the QR code from the bag gold sticker.*
- *Incomplete warranty will **VOID** your warranty.*
- *Keep your receipt if you do not register your warranty online.*
- *See **WARRANTY INFORMATION** for warranty coverage information.*

Packaging Contents:

- *Black zipper bag.*
- *12v (DC) MacDaddy fishing light.*
- *50-amp alligator clips (some light models).*
- *Top light flotation accessories.*
- *Bottom light anchoring accessories.*
- *Capt Lee Noga discontinued installing the 2 oz. lead sinker.*
- *Product user manual.*
- *Light deployment strategies manual.*
- *Warranty activation sticker reminder on the bag zipper.*
- *THANK YOU note.*

Smart Light Multimode

Single Mode Models **NOT** Included

Mode 1 - FULL POWER green/white LEDs is the preferred mode.

Mode 2 - GREEN LEDs, when you want a darker green light field.

Mode 3 - WHITE LEDs, use out of water for emergency light & repairs. **SEE WARNING.**

Mode 4 - HALF POWER both color LEDs at half power for shallow use.

Mode 5 - HIGH SPEED STROBE to bust up bait/catfish blacking out lights.

Mode 6 - LOW SPEED STROBE set light deep. Targets rise to surface.

Mode 7 - HALF POWER STROBE (same as Mode 6) for deep/shallow use.

Mode 8 - S.O.S. SIGNAL [BETA] in testing & not included in all lights.

Warning – *Using MODE 3, 5, 6, 7, & 8 requires reading the **PRODUCT SAFETY WARNING** section of this manual*

FLOTATION KIT ASSEMBLY

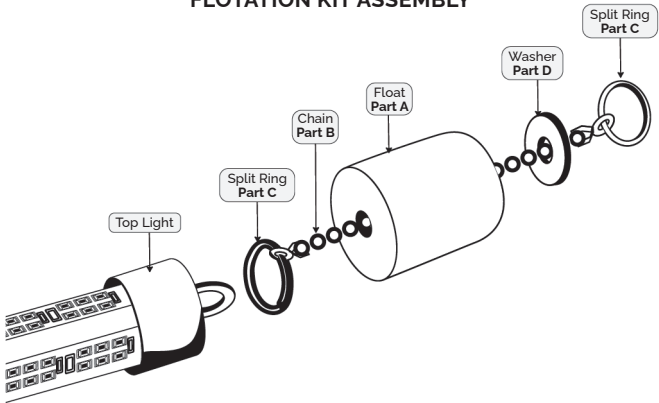

Flotation Kit Assembly (Top Of Light):

- **Part (A)** - Float (3x3) (1).
- **Part (B)** - SS Chain (1).
- **Part (C)** - SS Split Rings (4).
- **Part (D)** - SS Washer (1).

BOTTOM LIGHT ACCESSORIES

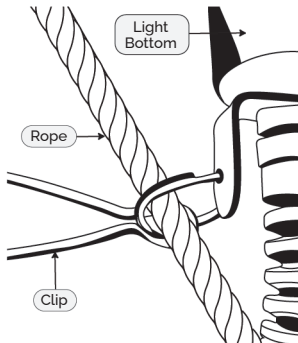
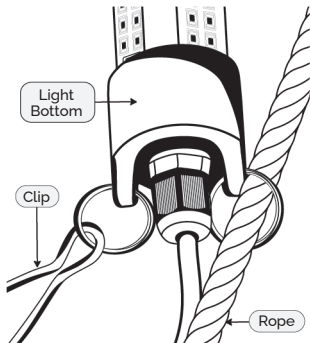

Bottom Light Accessories Installation:

- Thread the longline clip onto the split ring.
- Grey bottom cap – Thread longline split ring onto the metal hook.
- Grey bottom cap – Thread anchor rope into the longline split ring. Tie knot.
- Green bottom cap – Thread longline split ring to one of the hook holes.
- Green bottom cap – Add a 2nd empty split ring to the opposite hook hole.
- Green bottom cap – Thread anchor rope into the empty split ring. Tie knot.
- Use cable ties (rated 75 lbs) to secure the short rope piece to the main rope.
- Wrap electrical tape to cover the cable ties to protect your hands.

DEPRESS BUTTON TO CHANGE MODES

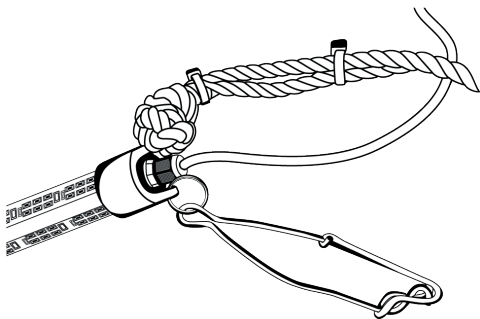
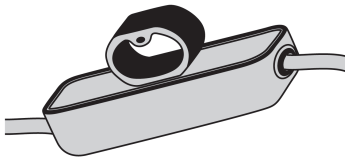
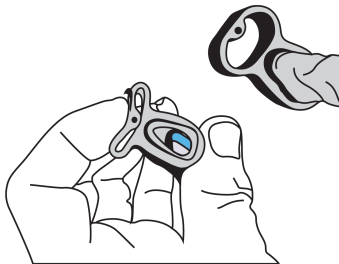

ATTENTION!

Setting Up The Light Anchor Rope Rigging

- *Leaded crab pot line is preferred. Cheap foam core rope floats.*
- *Rope thickness should be 5/16" or 3/8". Recommend 17-20 feet.*
- *Recommend attaching break away cable tie (75 lb.) to the anchor hook.*
- *Tie the rope end to the cable tie (75 lbs.) attached to the anchor hook.*
- *Secure the short rope tail to the main rope with cable ties.*
- *Use electrical tape to cover the cable ties to prevent injury to hands.*
- *Bring spare anchors. Every light deployment risks losing the anchor.*

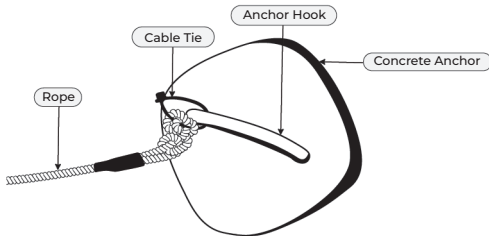

Light Anchor Weight Specifications:

- *Your anchor choice should be between 7-10 lbs. maximum.*
- *Round or mushroom type shape anchors slide & roll in current.*
- *Handheld square type weights & pyramid shapes are good.*
- *Be creative! The goal is to get the anchor to hold without sliding.*
- *Custom pour several types of anchors using concrete & U bolts.*
- *Cheap red clay pots & plastic containers make good molds.*
- *Bring spare light anchors. Every light deployment risks losing the anchor.*

MacDaddy Fishing Lights™ Specifications

	MacDaddy Single Mode™ PRO	MacDaddy Single Mode™ ULTRA	MacDaddy Smart Light® PRO	MacDaddy Smart Light® ULTRA
12V	Y	Y	Y	Y
# Modes	1	1	7/8	7/8
Button Control	N	N	Y	Y
Strobing Modes	N	N	Y	Y
Metal Frame	Y	Y	Y	Y
33 Ft Cord	Y	Y	Y	Y
Storage Bag	Y	Y	Y	Y
Light Deployment Manual	Y	Y	Y	Y
Flotation Kit	Y	Y	Y	Y
Anchor	N	N	N	N
Anchor Rope	N	N	N	N
Anchor Attachment Hook	Y	Y	Y	Y
Leaded Rope	N	N	N	N
Alligator Clips	Y	Y	Y	Y
LEDs – Green/White	Y	Y	Y	Y
Lumens [Before Build]	3 000	6 000	3 000	6 000
Amps	3	6/7	3	6/7
Watts	40	80	40	80
Warranty Years	2	2	2	2

ATTENTION!

[12v Light [DC] – needs a converter device to plug into AC power].

Battery Recommendations:

MacDaddy Single Mode™ (PRO) – 675 crank amps (2) lights.

MacDaddy Single Mode™ (ULTRA) – 675 crank amps (2) lights.

MacDaddy Smart Light® (PRO) – 1000 crank amps (2) lights.

MacDaddy Smart Light® (ULTRA) – 1000 crank amps (2) lights.

Warranty Information

- Contact **sales@marker69.com**. Do **NOT** contact the vendor.
- Marker69.com registers your light warranty when you buy direct.
- 2-year warranty for the lamp and cord. 90-day warranty on accessories.
- Warranty claims require proof of purchase or a warranty registration.
- Warranty will be voided for misuse, neglect, or unauthorized repairs.
- Warranty will be voided from damages resulting from excessive force.
- Warranty will be voided for power surges & DC volts > 12v.



PRODUCT SAFETY WARNING

The metal frame gets hot out of the water and can cause injury to your hands. Keep the light submerged when powered to prevent injury while using the other modes. If you have a sensitivity to flashing lights do not stare at the smart light when using modes (5-8). Cords laying on the deck can cause accidents. Deploy as much of the cord as possible into the water. Keep children and pets away from a powered light out of the water.

- Mode 3 [PRO] – **CAN** be used out of the water as a light source.
- Mode 3 [ULTRA] – **CANNOT** be used out of the water in any mode.

Light Maintenance

- *Rinse the light after every use to include the battery clips.*
- *Inspect the light and light cord for damage.*
- *Keep the light from being exposed to daylight indoors/outdoors.*
- *UV light will prematurely yellow the glue, store the lamp in the zipper bag.*
- *Use electrical grease to coat the spring inside the alligator clips.*
- *When replacing battery connectors, solder all exposed copper wire.*
- **DO NOT** use liquid tape to cover exposed wire. *This will fail the light.*
- **DO NOT** place cable ties direct to cord. *Place on electrical tape or tubing.*
- **DO NOT** store lights in hot cars or compartments.

UTILITY PATENT:

US 11,147,263

DESIGN PATENTS:

US D904,320

US D932,672

US D898,257

US D785,286

US D805,669

US D887,603

- © sales@marker69.com
- f www.facebook.com/groups/howtoshrimp
- © Training YouTube® Videos [Lee Noga] channel
- Ⓔ Product Resources, Help & Tools - MacDaddyFishingLights.com
- 🔗 Shrimping Resources - go to LeeNoga.com

All copyrighted and copyrightable materials, including, without limitation, the logo, design, text, graphics, pictures, copywriting and the selection and arrangement ("Materials")

Copyright © 2024 Marker 69 LLC